

RECEIVED
CLERK'S OFFICE

MAY 26 2006

STATE OF ILLINOIS
Pollution Control Board

INFORMATIONAL NOTICE !!!

Acde-45

IT IS IMPORTANT THAT YOU READ THE ENCLOSED DOCUMENTS.

NOTE: This Administrative Citation refers to TWO separate State of Illinois Agencies. One is the **ILLINOIS POLLUTION CONTROL BOARD** located at James R. Thompson Center, 100 West Randolph Street, Suite 11-500, Chicago, Illinois 60601. The other state agency is the **ILLINOIS ENVIRONMENTAL PROTECTION AGENCY** located at: 1021 North Grand Avenue East, P.O. Box 19276, Springfield, Illinois 61794-9276.

If you elect to contest the enclosed Administrative Citation, you must file a **PETITION FOR REVIEW** with **thirty-five (35) days** of the date the Administrative Citation was served upon you. Any such Petition for Review must be filed with the clerk of the Illinois Pollution Control Board by either hand delivering or mailing to the Board at the address given above. A copy of the Petition for Review should be either hand-delivered or mailed to the Illinois Environmental Protection Agency at the address given above and should be marked to the **ATTENTION: DIVISION OF LEGAL COUNSEL**.

Any person other than individuals **MUST** appear through an attorney-at-law licensed and registered to practice law. Individuals may appear on their own behalf, or through an attorney. 35 Ill. Adm. Code 101.400(a).

BEFORE THE ILLINOIS POLLUTION CONTROL BOARD
ADMINISTRATIVE CITATION

RECEIVED
CLERK'S OFFICE

MAY 26 2006

STATE OF ILLINOIS
Pollution Control Board

ILLINOIS ENVIRONMENTAL
PROTECTION AGENCY,

Complainant,

v.

WASTE MANAGEMENT OF ILLINOIS
INC., MARK BATHERSON and DALE
HOEKSTRA,

Respondents.

AC 06-45
(IEPA No. 95-06-AC)

NOTICE OF FILING

To: Waste Management of Illinois, Inc.
% C T Corporation System
208 S. LaSalle Street, Suite 814
Chicago, IL 60604-1101

Mark Batherson
29755 S. Prairie View Drive
Wilmington, IL 60481

Dale Hoekstra
29755 S. Prairie View Drive
Wilmington, IL 60481

PLEASE TAKE NOTICE that on this date I mailed for filing with the Clerk of the Pollution Control Board of the State of Illinois the following instrument(s) entitled ADMINISTRATIVE CITATION, AFFIDAVIT, and 811 SOLID WASTE LANDFILL INSPECTION CHECKLIST.

Respectfully submitted,

Michelle M. Ryan
Special Assistant Attorney General

Illinois Environmental Protection Agency
1021 North Grand Avenue East
P.O. Box 19276
Springfield, Illinois 62794-9276
(217) 782-5544

Dated: May 24, 2006

BEFORE THE ILLINOIS POLLUTION CONTROL BOARD

ADMINISTRATIVE CITATION

RECEIVED
CLERK'S OFFICE

MAY 26 2006

STATE OF ILLINOIS
Pollution Control Board

ILLINOIS ENVIRONMENTAL
PROTECTION AGENCY,

Complainant,

v.

WASTE MANAGEMENT OF ILLINOIS INC.,
MARK BATHERSON and DALE
HOEKSTRA,

Respondents.

AC *06-45*
(IEPA No. 95-06-AC)

JURISDICTION

This Administrative Citation is issued pursuant to the authority vested in the Illinois Environmental Protection Agency by Section 31.1 of the Illinois Environmental Protection Act, 415 ILCS 5/31.1 (2004).

FACTS

1. That Waste Management of Illinois Inc. is the permitted operator, Mark Batherson is the certified operator, and Dale Hoekstra is the Chief operator in responsible charge (collectively "Respondents") of a facility located at 29755 S. Prairie View, Wilmington, Will County, Illinois.

2. That said facility is a sanitary landfill, operating under Illinois Environmental Protection Agency Permit No. 1999-291-LF, and is designated with Site Code No. 1971105050. The facility is commonly known to the Illinois Environmental Protection Agency as Wilmington/Prairie View RDF.

3. That Respondents have operated said facility at all times pertinent hereto.

4. That on April 18, 2006, James Haennicke of the Illinois Environmental Protection Agency's Des Plaines Regional Office inspected the above-referenced facility. A copy of his

inspection report setting forth the results of said inspection is attached hereto and made a part hereof.

VIOLATIONS

Based upon direct observations made by James Haennicke during the course of his April 24, 2006 inspection of the above-referenced facility, the Illinois Environmental Protection Agency has determined that Respondents violated the Illinois Environmental Protection Act (hereinafter, the "Act") as follows:

- (1) That Respondents conducted a sanitary landfill in a manner which resulted in uncovered refuse remaining from the previous operating day or at the conclusion of any operating day, a violation of Section 21(o)(5) of the Act, 415 ILCS 5/21 (o)(5) (2004).

CIVIL PENALTY

Pursuant to Section 42(b)(4) of the Act, 415 ILCS 5/42(b)(4) (2004), Respondents are subject to a civil penalty of Five Hundred Dollars (\$500.00) for each of the violations identified above, for a total of Five Hundred Dollars (\$500.00). If Respondents elect not to petition the Illinois Pollution Control Board, the statutory civil penalty specified above shall be due and payable no later than June 30, 2006, unless otherwise provided by order of the Illinois Pollution Control Board.

If Respondents elect to contest this Administrative Citation by petitioning the Illinois Pollution Control Board in accordance with Section 31.1 of the Act, 415 ILCS 5/31.1 (2004), and if the Illinois Pollution Control Board issues a finding of violation as alleged herein, after an adjudicatory hearing, Respondents shall be assessed the associated hearing costs incurred by the Illinois Environmental Protection Agency and the Illinois Pollution Control Board. Those hearing costs shall be assessed in addition to the statutory civil penalty.

Pursuant to Section 31.1(d)(1) of the Act, 415 ILCS 5/31.1(d)(1) (2004), if Respondents fail to petition or elect not to petition the Illinois Pollution Control Board for review of this Administrative Citation within thirty-five (35) days of the date of service, the Illinois Pollution Control Board shall adopt a final order, which shall include this Administrative Citation and a finding of violation as alleged herein, and shall impose the statutory civil penalty specified above.

When payment is made, Respondents' check shall be made payable to the Illinois Environmental Protection Trust Fund and mailed to the attention of Fiscal Services, Illinois Environmental Protection Agency, 1021 North Grand Avenue East, P.O. Box 19276, Springfield, Illinois 62794-9276. Along with payment, Respondents shall complete and return the enclosed Remittance Form to ensure proper documentation of payment.

If any civil penalty and/or hearing costs are not paid within the time prescribed by order of the Illinois Pollution Control Board, interest on said penalty and/or hearing costs shall be assessed against the Respondents from the date payment is due up to and including the date that payment is received. The Office of the Illinois Attorney General may be requested to initiate proceedings against Respondents in Circuit Court to collect said penalty and/or hearing costs, plus any interest accrued.

PROCEDURE FOR CONTESTING THIS
ADMINISTRATIVE CITATION

Respondents have the right to contest this Administrative Citation pursuant to and in accordance with Section 31.1 of the Act, 415 ILCS 5/31/1 (2004). If Respondents elect to contest this Administrative Citation, then Respondents shall file a signed Petition for Review, including a Notice of Filing, Certificate of Service, and Notice of Appearance, with the Clerk of the Illinois Pollution Control Board, State of Illinois Center, 100 West Randolph, Suite 11-500, Chicago, Illinois 60601. A copy of said Petition for Review shall be filed with the Illinois Environmental Protection Agency's Division of Legal Counsel at 1021 North Grand Avenue East, P.O. Box 19276, Springfield, Illinois 62794-9276. Section 31.1 of the Act provides that any Petition for Review shall be filed within thirty-five (35) days of the date of service of this Administrative Citation or the Illinois Pollution Control Board shall enter a default judgment against the Respondents.

Douglas P. Scott, Director *by me*
Illinois Environmental Protection Agency

Date 5/24/06

Prepared by: Susan E. Konzelmann, Legal Assistant
Division of Legal Counsel
1021 North Grand Avenue East
P.O. Box 19276
Springfield, Illinois 62794-9276
(217) 782-5544

REMITTANCE FORM

RECEIVED
CLERK'S OFFICE

MAY 26 2006

STATE OF ILLINOIS
Pollution Control Board

ILLINOIS ENVIRONMENTAL)
PROTECTION AGENCY,)

Complainant,)

v.)

WASTE MANAGEMENT OF ILLINOIS INC.,)

MARK BATHERSON and DALE)

HOEKSTRA,)

Respondents.)

AC **06-45**
(IEPA No. 95-06-AC)

FACILITY: Wilmington/Prairie View RDF

SITE CODE NO.: 1971105050

COUNTY: Will

CIVIL PENALTY: \$500.00

DATE OF INSPECTION: April 18, 2006

DATE REMITTED:

SS/FEIN NUMBER:

SIGNATURE:

NOTE

Please enter the date of your remittance, your Social Security number (SS) if an individual or Federal Employer Identification Number (FEIN) if a corporation, and sign this Remittance Form. Be sure your check is enclosed and mail, along with Remittance Form, to Illinois Environmental Protection Agency, Attn.: Fiscal Services, P.O. Box 19276, Springfield, Illinois 62794-9276.

RECEIVED
CLERK'S OFFICE

MAY 26 2006

ILLINOIS ENVIRONMENTAL PROTECTION AGENCY

STATE OF ILLINOIS
Pollution Control Board

AFFIDAVIT

IN THE MATTER OF:

IEPA DOCKET NO.

RESPONDENT)

Affiant, James Haennicke, being first duly sworn,
voluntarily deposes and states as follows:

1. Affiant is a field inspector employed by the Land
Pollution Control Division of the Illinois Environmental
Protection Agency and has been so employed at all times pertinent
hereto.

2. On April 18, 2006, between 5:30 am and 7:30 am, Affiant
conducted an inspection of the Prairie View RDF landfill in Will
County, Illinois, known as Prairie View RDF , Illinois
Environmental Protection Agency Site No. 1971105050, operating
under IEPA Permit #1999-291-LF.

3. Affiant inspected said landfill site by an on-site
inspection, which included walking the site and interviewing
personnel.

4. Before and/or after said inspection of said landfill
site, Affiant reviewed Illinois Environmental Protection Agency
permits issued to the subject site and investigated into whether
or not required documents were timely filed on behalf of the
subject site.

5. As a result of the activities referred to in
Paragraphs 3 and 4 above, Affiant completed the Inspection Report
form attached hereto and made a part hereof, which, to the best

of Affiant's knowledge and belief, is an accurate representation
of Affiant's observations and factual conclusions with respect to
Prairie View RDF .

James Hannick

Subscribed and Sworn to before

me this 27th day of April, 2006

Darlene F. Armstrong
Notary Public

"OFFICIAL SEAL"
DARLENE F. ARMSTRONG
NOTARY PUBLIC, STATE OF ILLINOIS
MY COMMISSION EXPIRES 11/17/2006

ILLINOIS ENVIRONMENTAL PROTECTION AGENCY

811 Solid Waste Landfill Inspection Checklist

County: Will LPC#: 1971105050 Region: 2 - Des Plaines
 Location/Site Name: Wilmington/ Prairie View RDF
 Date: 4-18-06 Time: From 5:30 To 7:30 Previous Inspection Date: 1-11-06
 Inspector(s): James Haennicke Weather: 45F
 No. of Photos Taken: # 6 Samples Taken: Yes # No ☒
 Interviewed: Mark Batherson Facility Phone No.: 815 423 5120
815 423 5307-Fax

Permitted Owner Mailing Address

County of Will, Waste Services Division
 Dean Olson
 58 E Clinton St, Ste 500
 Joliet, IL 60432

Permitted Operator Mailing Address

Waste Management of Illinois Inc
 Ian Johnson
 29755 S Prairie View Dr
 Wilmington, IL 60481

RECEIVED
 APR 26 2006
IEPA/BOL

Chief Operator Mailing Address

Dale Hoekstra
 29755 S Prairie View Dr
 Wilmington, IL 60481

Certified Operator Mailing Address

Mark Batherson
 29755 S Prairie View Dr
 Wilmington, IL 60481

AUTHORIZATION:

Significant Modification Permit
 Initial: 1999-291-LF
 Latest 13

OPERATIONAL STATUS:

Operating ☒
 Closed-Not Certified. ☐
 Closed-Date Certified:

TYPE OF OPERATION:

Existing Landfills 814-Subpart C ☐
 814-Subpart D ☐
 New Landfills: 811-Putres./Chem. ☒

	SECTION	DESCRIPTION	VIOL
ILLINOIS ENVIRONMENTAL PROTECTION ACT REQUIREMENTS			
1.	9(a)	CAUSE, THREATEN OR ALLOW AIR POLLUTION IN ILLINOIS	<input type="checkbox"/>
2.	9(c)	CAUSE OR ALLOW OPEN BURNING	<input type="checkbox"/>
3.	12(a)	CAUSE, THREATEN OR ALLOW WATER POLLUTION IN ILLINOIS	<input type="checkbox"/>
4.	12(d)	CREATE A WATER POLLUTION HAZARD	<input type="checkbox"/>
5.	12(f)	CAUSE, THREATEN OR ALLOW DISCHARGE WITHOUT OR IN VIOLATION OF AN NPDES PERMIT	<input type="checkbox"/>
6.	21(a)	CAUSE OR ALLOW OPEN DUMPING	<input type="checkbox"/>
7.	21(d)	CONDUCT ANY WASTE-STORAGE, WASTE-TREATMENT, OR WASTE- DISPOSAL OPERATION:	
	(1)	Without a Permit or in Violation of Any Conditions of a Permit (See Permit Provisions)	<input type="checkbox"/>
	(2)	In Violation of Any Regulations or Standards Adopted by the Board	<input type="checkbox"/>
8.	21(e)	DISPOSE, TREAT, STORE, OR ABANDON ANY WASTE, OR TRANSPORT ANY WASTE INTO THE STATE AT/TO SITES NOT MEETING REQUIREMENTS OF ACT AND REGULATIONS	<input type="checkbox"/>
9.	21(f)(1)	CONDUCT ANY HAZARDOUS WASTE-STORAGE, TREATMENT OR DISPOSAL OPERATION WITHOUT A RCRA PERMIT.	<input type="checkbox"/>

10.	21(o)	CONDUCT A SANITARY LANDFILL OPERATION WHICH RESULTS IN ANY OF THE FOLLOWING CONDITIONS:	
	(1)	Refuse in Standing or Flowing Water	<input type="checkbox"/>
	(2)	Leachate Flows Entering Waters of the State	<input type="checkbox"/>
	(3)	Leachate Flows Exiting the Landfill Confines	<input type="checkbox"/>
	(4)	Open Burning of Refuse in Violation of Section 9 of the Act	<input type="checkbox"/>
	(5)	Uncovered Refuse Remaining From Any Previous Operating Day or at the Conclusion of Any Operating Day	<input checked="" type="checkbox"/>
	(6)	Failure to Provide Final Cover Within Time Limits	<input type="checkbox"/>
	(7)	Acceptance of Wastes Without Necessary Permits	<input type="checkbox"/>
	(8)	Scavenging as Defined by Board Regulations	<input type="checkbox"/>
	(9)	Deposition of Refuse in Any Unpermitted Portion of the Landfill	<input type="checkbox"/>
	(10)	Acceptance of Special Waste Without a Required Manifest	<input type="checkbox"/>
	(11)	Failure to Submit Reports Required by Permits or Board Regulations	<input type="checkbox"/>
	(12)	Failure to Collect and Contain Litter by the End of each Operating Day	<input type="checkbox"/>
	(13)	Failure to Submit Any Cost Estimate, Performance Bond or Other Security	<input type="checkbox"/>
11.	21(t)	CAUSE OR ALLOW A LATERAL EXPANSION OF A MUNICIPAL SOLID WASTE LANDFILL (MSWLF) UNIT WITHOUT A PERMIT MODIFICATION	<input type="checkbox"/>
12.	21.6(b)	ACCEPTANCE OF LIQUID USED OIL FOR FINAL DISPOSAL (EFFECTIVE JULY 1, 1996)	<input type="checkbox"/>
13.	22.01	FAILURE TO SUBMIT ANNUAL NONHAZARDOUS SPECIAL WASTE	<input type="checkbox"/>
14.	22.17	LANDFILL POST-CLOSURE CARE	
	(a)	Failure to Monitor Gas, Water, Settling	<input type="checkbox"/>
	(b)	Failure to Take Remedial Action	<input type="checkbox"/>
15.	22.22(c)	ACCEPTANCE OF LANDSCAPE WASTE FOR FINAL DISPOSAL	<input type="checkbox"/>
16.	22.23(f)(2)	CAUSE OR ALLOW THE DISPOSAL OF ANY LEAD-ACID BATTERY	<input type="checkbox"/>
17.	22.28(b)	ACCEPTANCE OF WHITE GOODS FOR FINAL DISPOSAL	<input type="checkbox"/>
18.	55(b)(1)	ACCEPTANCE OF ANY USED OR WASTE TIRE FOR FINAL DISPOSAL (UNLESS LANDFILL MEETS EXEMPTION OF 55(b)(1))	<input type="checkbox"/>
19.	56.1(a)	CAUSE OR ALLOW THE DISPOSAL OF ANY POTENTIALLY INFECTIOUS MEDICAL WASTE	<input type="checkbox"/>
SOLID WASTE SITE OPERATOR CERTIFICATION LAW REQUIREMENTS			
20.	225 ILCS 230/1004	CAUSING OF ALLOWING OPERATION OF A LANDFILL WITHOUT PROPER COMPETENCY CERTIFICATE	<input type="checkbox"/>
35 ILLINOIS ADMINISTRATIVE CODE REQUIREMENTS SUBTITLE G			
PRIOR CONDUCT CERTIFICATION REQUIREMENTS			
21.	745.181	CHIEF OPERATOR REQUIREMENTS	<input type="checkbox"/>
22.	745.201	PRIOR CONDUCT CERTIFICATION PROHIBITIONS	<input type="checkbox"/>
SPECIAL WASTE HAULING REQUIREMENTS			
23.	809.301	REQUIREMENTS FOR DELIVERY OF SPECIAL WASTE TO HAULERS	<input type="checkbox"/>

	PART 811 SUBPART G	FINANCIAL ASSURANCE	
52.	811.700	COMPLY WITH FINANCIAL ASSURANCE REQUIREMENTS OF PART 811, SUBPART G	<input type="checkbox"/>
53.	811.701	UPGRADING FINANCIAL ASSURANCE	<input type="checkbox"/>
54.	811.704	CLOSURE AND POST-CLOSURE CARE COST ESTIMATES	<input type="checkbox"/>
55.	811.705	REVISION OF COST ESTIMATE	<input type="checkbox"/>
SOLID WASTE FEE SYSTEM REQUIREMENTS			
56.	Part 858 Subpart B	MAINTAINED, RETAINED & SUBMITTED DAILY & MONTHLY SOLID WASTE RECORDS AND QUARTERLY SOLID WASTE SUMMARIES WHERE INCOMING WASTE IS WEIGHED (LIST SPECIFIC SECTION	<input type="checkbox"/>
57.	Part 858 Subpart C	MAINTAINED, RETAINED & SUBMITTED DAILY & MONTHLY SOLID WASTE RECORDS AND QUARTERLY SOLID WASTE SUMMARIES WHERE INCOMING WASTE IS NOT WEIGHED (LIST SPECIFIC	<input type="checkbox"/>
OTHER REQUIREMENTS			
58.	OTHER:	APPARENT VIOLATION OF: (<input type="checkbox"/>) PCB; (<input type="checkbox"/>) CIRCUIT COURT CASE NUMBER: ORDER ENTERED ON:	<input type="checkbox"/>
59.			<input type="checkbox"/>
			<input type="checkbox"/>
			<input type="checkbox"/>
			<input type="checkbox"/>
			<input type="checkbox"/>

Informational Notes

1. [Illinois] Environmental Protection Act: 415 ILCS 5/4.
2. Illinois Pollution Control Board: 35 Ill. Adm. Code, Subtitle G.
3. Statutory and regulatory references herein are provided for convenience only and should not be construed as legal conclusions of the Agency or as limiting the Agency's statutory or regulatory powers. Requirements of some statutes and regulations cited are in summary format. Full text of requirements can be found in references listed in 1. and 2. above.
4. The provisions of subsection (o) of Section 21 of the [Illinois] Environmental Protection Act shall be enforceable either by administrative citation under Section 31.1 of the Act or by complaint under Section 31 of the Act.
5. This inspection was conducted in accordance with Sections 4(c) and 4(d) of the [Illinois] Environmental Protection Act: 415 ILCS 5/4(c) and (d).
6. Items marked with an "NE" were not evaluated at the time of this inspection.

PAGES 3-5 OMITTED AS NO VIOLATIONS WERE MARKED

1971105050 – Will
Prairie View RDF
FOS
April 18, 2006
James Haennicke

RECEIVED

APR 26 2006

IEPA/BOL

NARRATIVE

On, April 18, 2006, I conducted a solid waste inspection at the Prairie View RDF landfill located in Wilmington. I met with certified operator Mark Batherson who provided necessary information and accompanied me on a tour of the site.

Prairie View received its permit on September 24, 2003 and began accepting waste on January 19, 2004. The following is a list of permit modifications:

- 1- issued on January 16, 2004, approving the construction acceptance report for Phase 1A South, revised closure and post-closure care cost estimates, and addition of shallow groundwater monitoring well G04S
- 2- issued on March 3, 2004, approving the construction acceptance report for and operation of Phase 1B South
- 3- issued on April 20, 2004, approving landfill equipment washing procedures
- 4- issued on August 9, 2004, approving closure/post-closure cost estimates, revised AGQS/MAPC values for atrazine and parathion, addition of delta-BHC and phosphorus to the annual groundwater parameters, and the correction of the STORET number for 1,2-Dichloroethylene on leachate list L2
- 5- issued on September 13, 2004, approving the operation of Phase 1 North disposal area
- 6- issued on October 4, 2004, approving the operation of a C&D recycling area
- 7- issued on December 21, 2004, approving the operation of Phase 2 West
- 8- issued on February 10, 2005, approving proposal to develop intrawell AGQS values for groundwater monitoring wells; and methane monitoring report at gas probe GP-2
- 9- issued on June 17, 2005, approving revised closure and post-closure care cost estimates, use of bio-remediated soils as alternate daily cover, optional design for horizontal gas collection piping on liner base, submittal date revision for phosphorus AGQS values, and the use of asphalt pad for empty roll-off boxes
- 10- issued on July 22, 2005, approving the interwell pH and Delta-BHC values, shallow well G04S intrawell AGQS values, revised total recoverable phenol AGQS value, and the addition of parameters 2-propanol and ethyl methacrylate to the G2 monitoring list
- 11- issued November 14, 2005, approving the operation of Phase 2 East
- 12- issued December 8, 2005, approving groundwater monitoring changes
- 13- issued February 8, 2006, approving proposed construction of a temporary odor control system and revised closure plan and closure cost estimates

The site currently accepts approximately 3,000 tons of waste per day. Approximately 40% of the incoming waste consists of declassified and special wastes. Unauthorized wastes have rarely been encountered. Much of the waste accepted for disposal comes from area transfer stations where unauthorized wastes are first removed. The few tires and white goods that were found in incoming loads were returned to the originating transfer station for proper handling.

Special waste pre-acceptance forms, analyses, and manifests appeared adequate.

The C&D recycling area has not yet been put into use.

Plastic panels are used for daily cover whenever possible to save on air space. A daily record is kept for this activity. Uncovered refuse from a previous operating day was observed at the active fill area in Phase 1, as well as, at Phase 2 where ash waste is being disposed of separately from general refuse. (21(o)5)

Load checking inspections are conducted and recorded weekly.

A portable propane-fired canon is utilized for vector control at the active area. The unit emits automatic thunderclaps that deter pest birds and other nuisance wildlife.

Surveillance cameras are utilized at the ticket/administration building to record and observe vehicles. The images are archived for three months.

Approximately 443,350 gallons of leachate were generated in March. A 5,000-gallon mobile leachate storage tank is utilized to collect this waste from the side slope risers. This wastestream is transferred to the leachate holding tank or another tanker for shipment, via manifest, to Kankakee Metro WWF located in Kankakee. Calculated levels for the invert for the collection pipes at the side slope riser sumps are: L301- 35"; L302- 36.5".

Gas probes 1 through 5 are tested monthly for methane, pressure, nitrogen, oxygen, and carbon dioxide. Ambient air monitoring devices test the air downwind of the landfill for methane. SMC 2001 combination gas monitors are located in the basement of the ticket/administration building and the break room of the maintenance building to continuously monitor methane.

The maintenance department of the landfill generates used oil, antifreeze, and soap solution from a parts washer. These wastes are generated from the maintenance of facility vehicles and equipment. A contract with Future Environmental located in Mokena, IL has been initiated for the disposal of these wastes. The last shipment of 500 gallons of used oil was shipped to Future on March 16, 2006. Wash water from cleaning equipment is also generated at the maintenance shop. This waste was last shipped on March 30, 2006 to Kankakee Metro WWF located in Kankakee.

During a review of Agency files, it was determined that Prairie View RDF has been listing Honorable Debbie Halvorson's address as Chicago instead of Chicago Heights on form LPC-PA16- Notice of Application for Permit to Manage Waste. Prairie View RDF's environmental engineer Ian Johnson was informed of this matter and will correct the document for future applications.

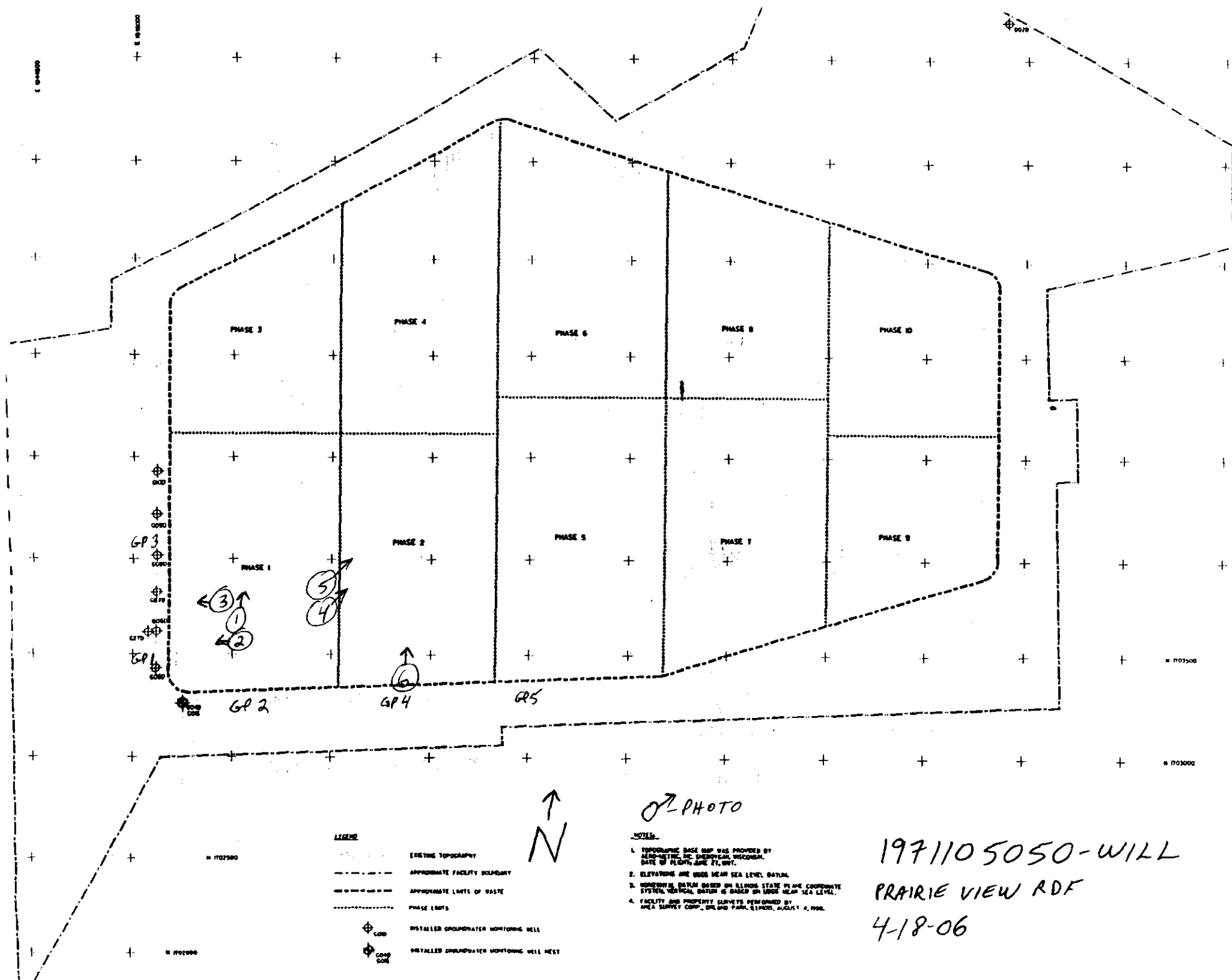



DIGITAL PHOTOGRAPHS File Names: 1971105050~04182006 -[Exp. #].jpg



Date: 4-18-06
Time: 5:30- 7:30
Direction: N
Photo by: James
Haennicke
Exposure #: 1
Comments:
Uncovered refuse
remaining from a
previous operating
day



Date: 4-18-06
Time: 5:30- 7:30
Direction: W
Photo by: James
Haennicke
Exposure #: 2
Comments:
Uncovered refuse
remaining from a
previous operating
day



DIGITAL PHOTOGRAPHS File Names: 1971105050~04182006 -[Exp. #].jpg



Date: 4-18-06
Time: 5:30- 7:30
Direction: W
Photo by: James
Haennicke
Exposure #: 3
Comments:
Uncovered refuse
remaining from a
previous operating
day



Date: 4-18-06
Time: 5:30- 7:30
Direction: NE
Photo by: James
Haennicke
Exposure #: 4
Comments: Sodium
sulfate ash (red
water incineration
of TNT production)
disposal at Phase
2



DIGITAL PHOTOGRAPHS File Names: 1971105050~04182006 -[Exp. #].jpg



Date: 4-18-06
Time: 5:30- 7:30
Direction: NE
Photo by: James
Haennicke
Exposure #: 5
Comments: Close up
of uncovered
sodium sulfate ash
refuse remaining
from a previous
operating day at
Phase 2



Date: 4-18-06
Time: 5:30- 7:30
Direction: N
Photo by: James
Haennicke
Exposure #: 6
Comments: Leachate
side slope riser
LP2

PROOF OF SERVICE

I hereby certify that I did on the 24th day of May 2006, send by Certified Mail, Return Receipt Requested, with postage thereon fully prepaid, by depositing in a United States Post Office Box a true and correct copy of the following instrument(s) entitled ADMINISTRATIVE CITATION, AFFIDAVIT, and 811 SOLID WASTE LANDFILL INSPECTION CHECKLIST

To: Waste Management of Illinois, Inc.
% C T Corporation System
208 S. LaSalle Street, Suite 814
Chicago, IL 60604-1101
Cert # 7002 3150 0000 1109 1617

Mark Batherson
29755 S. Prairie View Drive
Wilmington, IL 60481
Cert #7002 3150 0000 1109 1600

Dale Hoekstra
29755 S. Prairie View Drive
Wilmington, IL 60481
7002 3150 0000 1109 1778

and the original and nine (9) true and correct copies of the same foregoing instruments on the same date by Certified Mail, Return Receipt Requested, with postage thereon fully prepaid

To: Dorothy Gunn, Clerk
Pollution Control Board
James R. Thompson Center
100 West Randolph Street, Suite 11-500
Chicago, Illinois 60601
Cert # 7002 3150 0000 1109 1624



Michelle M. Ryan
Special Assistant Attorney General

Illinois Environmental Protection Agency
1021 North Grand Avenue East
P.O. Box 19276
Springfield, Illinois 62794-9276
(217) 782-5544

THIS FILING SUBMITTED ON RECYCLED PAPER